

Incredible **100,000 hrs**

GENERAL DESCRIPTION

Neptun's Security Light Fixture is suitable for a variety of outdoor applications. The 20 series Security Light is offered in a several wattages and features an integrated photocell for Dusk-to-Dawn On/Off control. It can replace existing HID & HPS fixtures up to 175W.

APPLICATION

- Street Lighting
- Alley Lighting
- Work Yard Lighting
- Parking Lot Lighting
- Security Lighting
- Barn Lighting
- Area Lighting
- Walkway Lighting

STRUCTURE, MATERIALS, & FEATURES

- Heavy-gauge, die-cast aluminum housing.
- Custom designed anodized aluminum reflectors for superior illuminance.
- Heat and impact resistant, UV protected, non yellowing lens.
- Corrosion resistant electrocoat grey finish (custom colors available).
- Slip Fitter mount accepts 1-1/4" - 2" Round Pipe or Tenon.
- Inductively coupled U-Type Induction bulb.
- High power factor, low THD electronic ballast with surge protection.
- NEMA Photocell for Dusk-to-Dawn On/Off control included.
- Instant-On flicker-free Cold Start and Hot Re-Start.
- High quality glare-free light with high CRI above (83).
- Bright white light (5000°K) for greater visibility and safety.
- Advance phosphors for high lumen output and high lumen maintenance.
- Up to 20 year maintenance free operation.
- 10 Year Warranty.

ORDERING INFORMATION

Sample Number: 20050-UNV-850-GRY
 Custom options and accessories available. Please consult factory

Series	Lamp Wattage	Voltage	Color Temp	Color
20 = Security Light	050 = 50 W 065 = 65 W 080 = 80 W	UNV = 120-277 VAC	830 = 3000°K 841 = 4100°K 850 = 5000°K* * Standard	GRY = Grey * Custom Colors Available



lightinnovations@work™

PRODUCT INFORMATION

Model No.	Description	Rated Watts	Input Watts	Initial Lumens	Universal Line Voltage (VAC)	Max Line Current (Amp) 120 - 277	THD	Power Factor	Weight
20050-UNV	Security Fixture	50	52	4,000	120-277	0.46-0.21	<10%	0.98	10 lbs
20080-UNV	Security Fixture	65	67	5,200	120-277	0.56-0.24	<10%	0.98	10 lbs
20080-UNV	Security Fixture	80	82	6,400	120-277	0.75-0.30	<10%	0.98	10 lbs

SPECIFICATIONS

- Ballast Type Electronic
- Start Method InstantON
- Hot Re-start InstantON
- Universal Input Line Voltage 120-277 VAC
- Input Line Frequency 50/60 Hz
- Lamp Operating Frequency 250 kHz
- Ballast Off-State Draw 0 Watts
- Sound Rating Class A
- ANSI Surge Protection Class A
- Lamp / Ballast System Life 100,000 Hrs.
- Lumen Maintenance @75,000Hrs > 70%
- Color Temperature 5000°K
- Color Rendering Index (CRI) 83
- Minimum Starting Temperature -20°F
- Maximum Starting Temperature 160°F
- Lumens per Watt 80
- Shock / Vibration Resistant Yes
- Power Factor > 0.98
- Total Harmonic Distortion < 10%
- Inrush Current Peak < 10 Amp
- ETL Listed / UL Standard 1598 Yes
- FCC Compliance Part 18, Subp. C
- IP Rating IP 55
- Warranty 10 Year

MOUNTING OPTIONS

Pole Mount



Accepts 1-1/4" - 2" Round Tenon or Pole (Hardware included)

Wall Mount

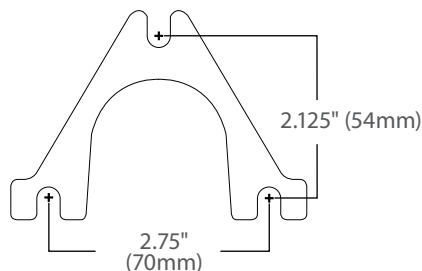

(Hardware Not included)

PHOTOMETRICS (See Complete IES File)

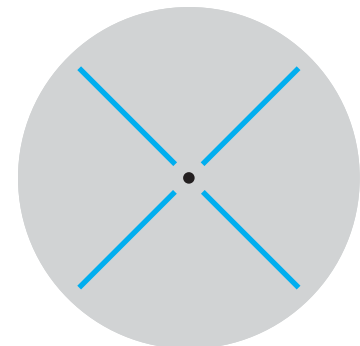

Type V Distribution

Neptun Light, Inc.
13950 Business Center Drive
Lake Forest, IL 60045
Fax: 847.735.8004

Neptun Light, Inc. reserves the right to change materials or modify the design of its product without notification as part of the company's continuing product improvement program.
©2002-2016 Neptun Light, Inc. All rights reserved. Spec. Rev. 4-2016